



NEO SCAFFOLDING

Innovation **Global Company**

www.neoscaffolding.com

Creative Stability 2gether 1st

Contents

- 01 | Ceo Greetings
- 02 | History
- 03 | Manufacturing and Technology Overview
- 04 | Assembly procedure
- 05 | Product Description
- 06 | Past Performances
- 07 | Patent & Certificate
- 08 | IOT SENSOR R&D DATA



CEO MESSAGE

Due to the new changes in the domestic construction materials market, and to supply safe and high quality building materials, Neo Scaffold Co., Ltd., has made a new start.

Based on domestic patented products, We have started new competitiveness, stability and originality.

Through the SMART FACTORY production process, We will advance to a trustworthy company that leads the safety and standardization of products.

Thank you.

NEO CEO 정 훈 조



HISTORY

2017.12	Established Nemo Scaffold Co., Ltd.
2018.01	Registered patent of scaffold frame.
2018.04	Registered as a partner company of Samsung Electronics.
2018.06	Obtained authorization of the research institute. Established branch office of Nemo Scaffold M&C Co., Ltd.
2018.09	Registered to Anyang Architects Association (Kyunggi-do, South Korea).
2018.09	Applied a new scaffolding frame patent.
2018.10	Began production of new scaffolding frame.
2018.10	Certified ISO9001.
2019.05	Yangsan factory establishment.
2019.05	Obtain T-4 rating for corporate technology evaluation.
2019.06	Rename Neo Scaffold Co., Ltd.
2019.08	Acquiring KCs certification from the Korea Occupational Safety and Health Corporation.
2019.11	Samsung Biologics Contract.
2020.01	Young Poong Seokpo smelter Contract.

Manufacturing and Technology Overview



Product Technology Overview

Purpose of use	All construction site basic temporary resources
Apply Sector	All construction sites at home and abroad
Size	Same as existing third party products
Weight	11kg (Single supply)
Working voltage	No voltage
Material	Aluminum (6061-T6)
Note	No limit on reuse

Neo System Scaffolding?

High-strength aluminium made by supplementing the disadvantages of conventional steel pipes and system scaffolding. Wedge the specified members with a square system scaffold. Prevent the risk of shaking and breaking away from the site by simple construction methods. It is easy and fast by reducing construction period and minimizing number of workers. It's a scaffold that creates a safe environment.

Advantages



Comparative table

Steel Pipe System Scaffold		Neo System Scaffolding
-	Patent	South Korea patent
About 16kg	Weight	About 11kg
STEEL	Material	ALUMINIUM 6061-T6
Extrusion Method	Method of production	Extrusion Method
About 5 years	Period of use	Semi-permanent
About 80 times	Usage	Semi-permanent
Construction is fast by 6m	Construction	Construction is fast by 6m
Frequent crashes occur	Safety during installation	Be safe and fast
Hard to get organized by piling up	Storage	Be easy to arrange by stacking up
Heavy weight makes it difficult to transport large quantities	Transport	Lower transportation costs with lighter weight than traditional scaffolding

시스템비계 System Scaffolding

Assembly procedure

- After securing the space, the use of vertical member octagon and horizontal member wedge assemblies allows for a solid installation in a short time.
- No tools are required for installation and the rubber hammer can run efficiently.

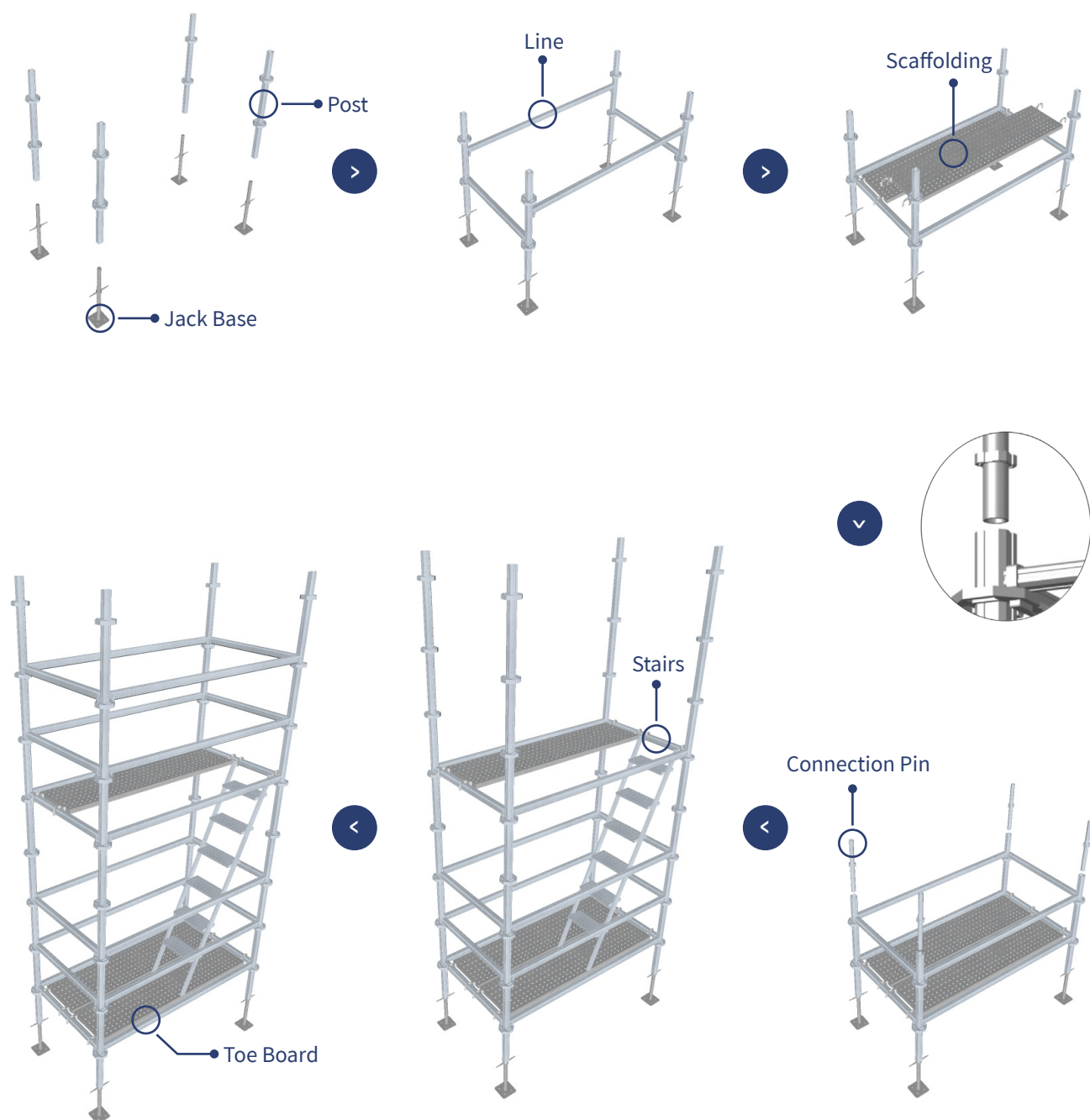

Material

Aluminium 6061-T6

SIZE	Length(mm)	Weight(kg)
OVB3780	3780	12.4
OVB2830	2830	9.3
OVB1880	1880	6.16
OVB930	930	3.05
OVB455	455	1.5

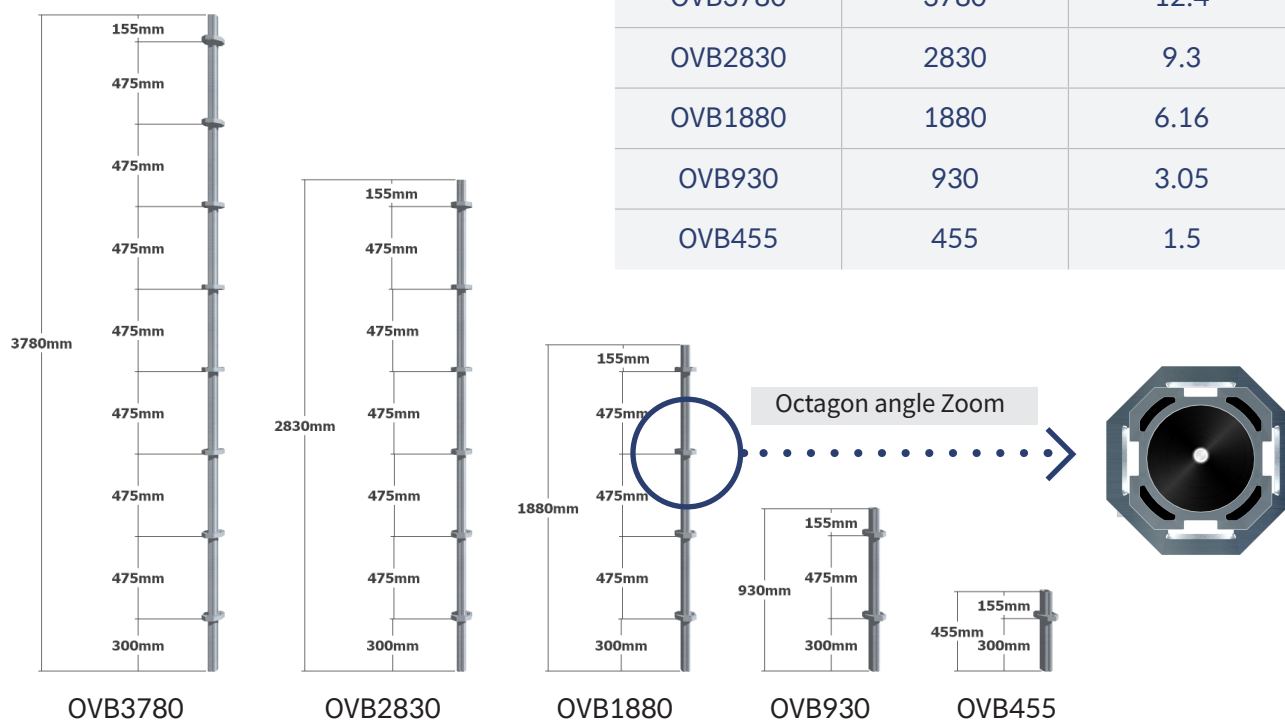

잭베이스
Jack Base

SIZE
Ø34 * 600L
Weight(kg)
3.03

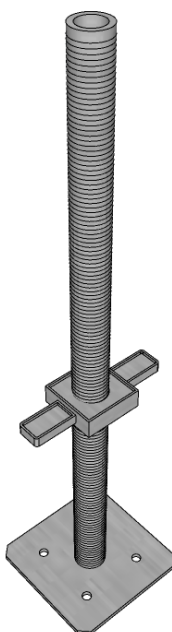

연결핀 Connection Pin

SIZE
Ø20 * 300
Weight(kg)
0.39



시스템비계 System Scaffolding

Completed KCs Safety Certification

수평재 Horizontal member

Material

Aluminium 6061-T6

Size	Length(mm)	Weight(kg)
OHB1829	1779	4.46
OHB1524	1474	3.75
OHB1219	1169	3.01
OHB914	864	2.30
OHB610	560	1.58
OHB305	255	0.86

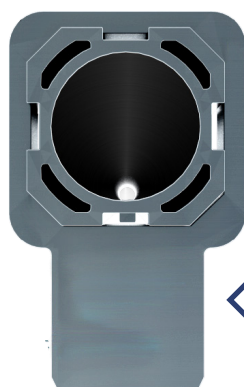

Vertical member wedge Zoom

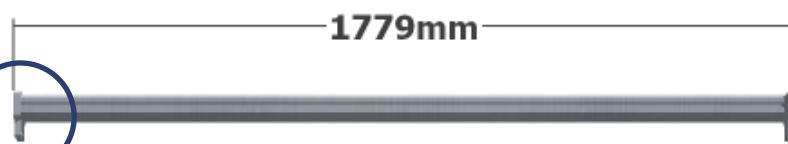

OHB1829

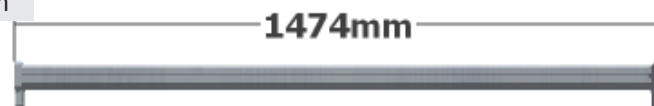

OHB1524



OHB1219

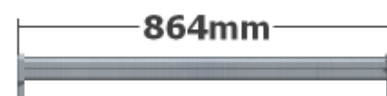

OHB914

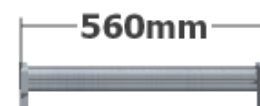

OHB610



OHB305

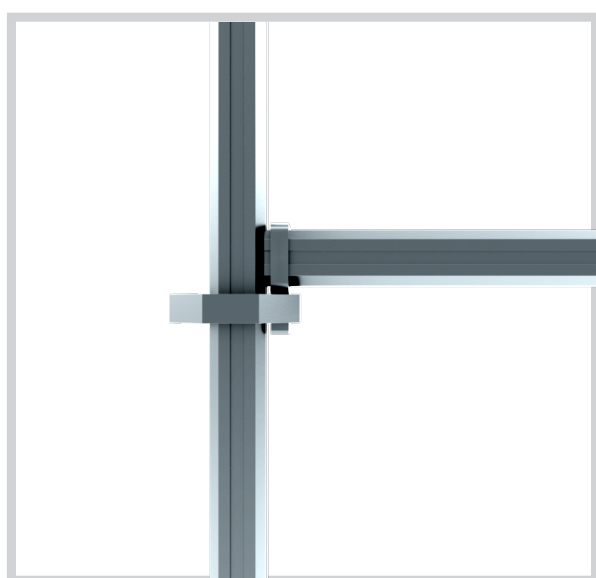

▲ Vertical and Horizontal
Member Connections

안전발판 Safety Scaffolding

- * STEEL / Aluminium Type
- * Aluminium scaffolding customizable

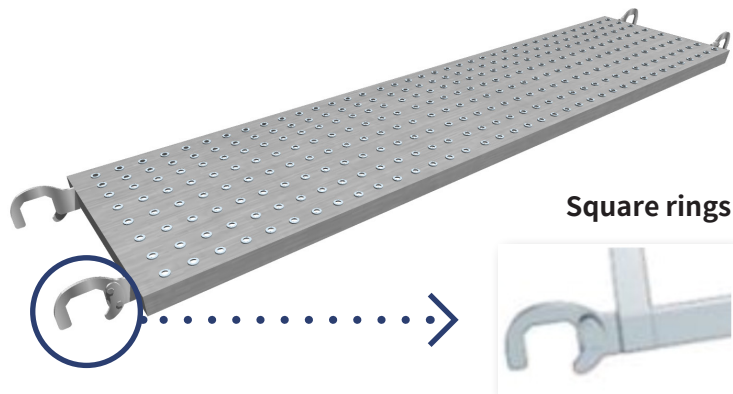

Circle / Square Type

Wide(W)	Length(mm)
400/500	1829
400/500	1524
400/500	1219
400/500	914
400/500	610

해치발판 Hatch Scaffolding

- * STEEL / Aluminium Type
- * Aluminium scaffolding customizable

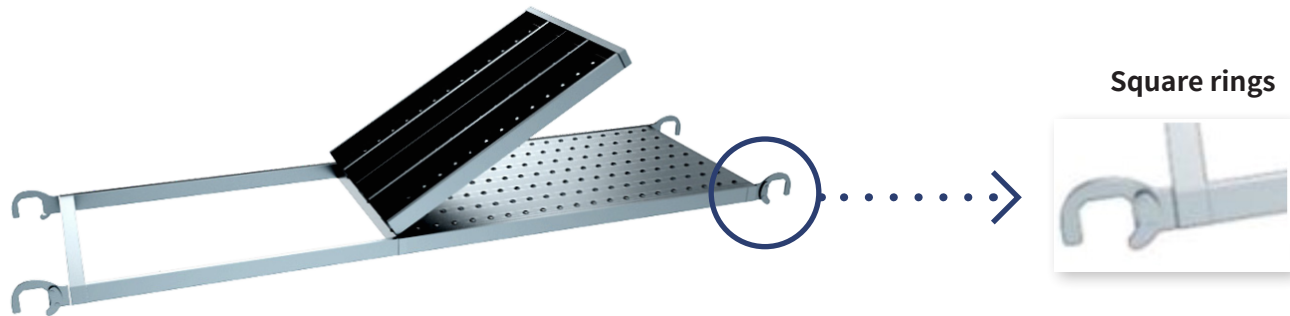

Circle / Square Type

Wide(W)	Length(mm)
500	1829

발끝막이판 Toe board

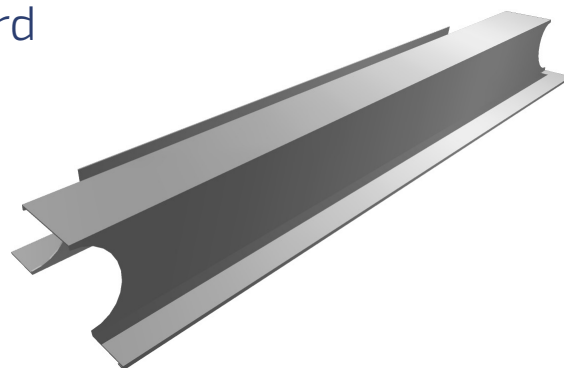

Circle / Square Type

Length(mm)
1819
1514
1209
904
600

시스템비계 System Scaffolding

시스템비계용 계단 System Scaffolding Stair

Size	Width(mm)	Length(mm)
400x2637	400	2637
500x2637	500	2637

* STEEL / Aluminium Type

* Aluminium stair customizable

* Handrail (Stair Railing) Attachable

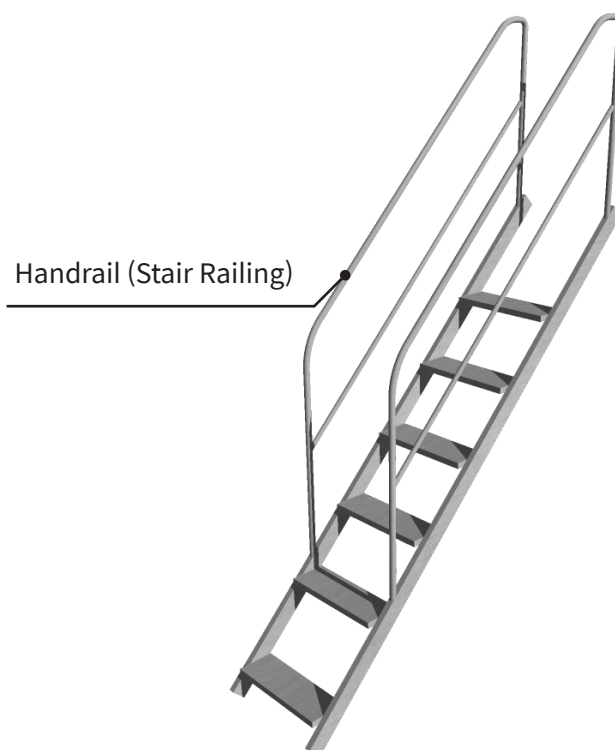
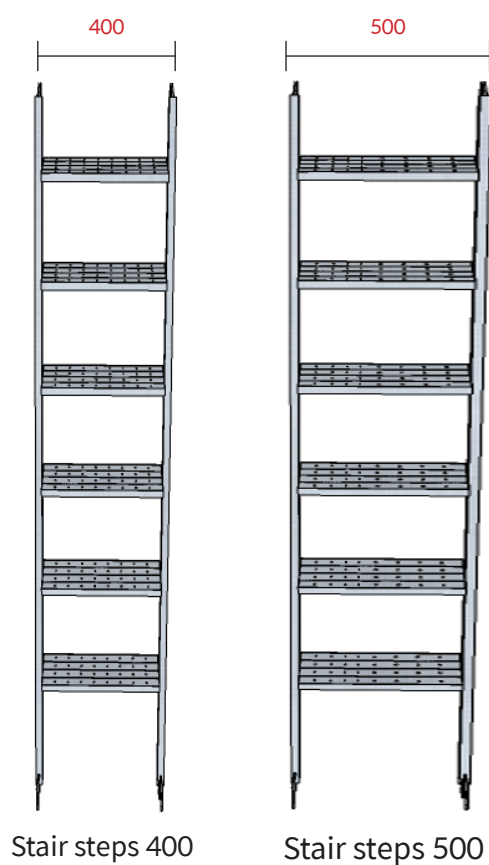

사다리 Stepladder

Size	Wide(mm)	Length(mm)
400x1700	400	1700

* STEEL / Aluminium Type

* Aluminium Stepladder customizable



프로파일(파이프) Profile(Pipe)

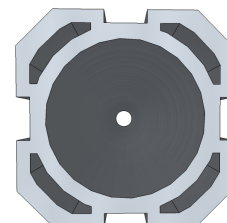

Spec

Material	Size	O.D(Ø)	Thickness	Weight(kg)
6061-T6	5800	50	3.5	13.63

Accessory



▲Fixed clamp



▲Rotational clamp



▲Safety cap



▲Caster(Wheel)

트러스 Truss

Size	Weight(kg)
TR 5487	45
TR 3658	30

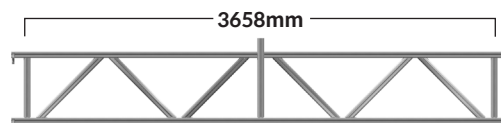
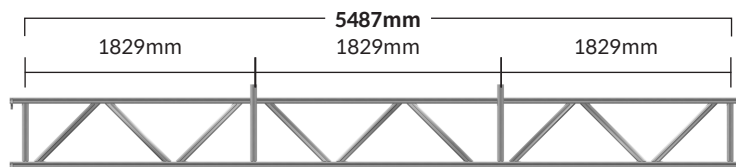

브라켓 Bracket

Weight(kg)
5.20

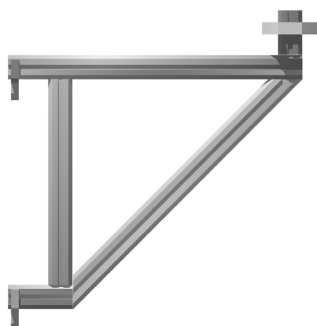

아웃트리거(전도방지대) Outrigger

Weight(kg)
9.23

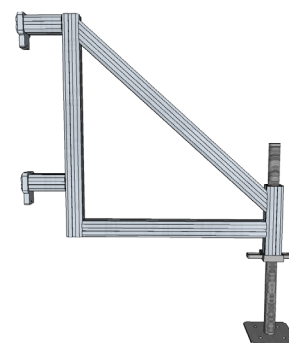

시스템비계 System Scaffolding

안전난간 우마작업대 Custom-made Workbench

- Safety rails & Safety Scaffolding & Toe board (100mm) attached to secure working.



* Made to order according to requirements.



W(mm)	D(mm)	H(mm)	H-1(mm)	L(mm)	F(mm)
600	1500	1200	1100	1200	250

Past Performances

- Construction case Architecture



▲ Former Hasung-myeon Office
in Kimpo



▲ On the spot of Samsung-dong,
Goyang, Gyeonggi-do



▲ POSCO PLANTEC

- Construction case Built-up Scaffolding



▲ Hanho Art in Paju



▲ Young Poong Seokpo smelte



▲ Samsung Biologics

- Construction case Art



▲ Kimjungup Architecture Museum



▲ Lee Kwang Ki Studio KKI in Paju

특허 및 인증서 Patent & Certificatee

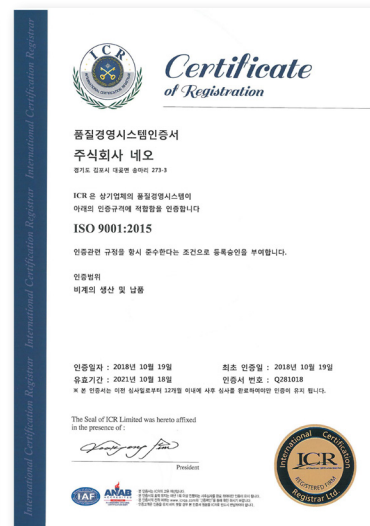
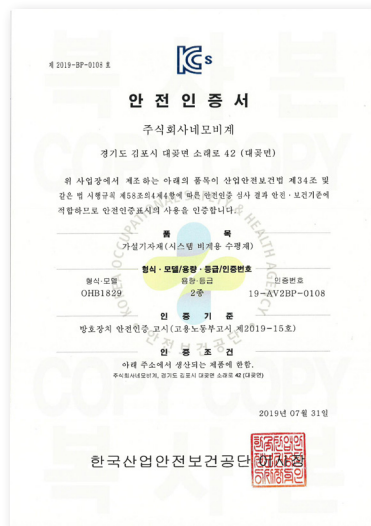
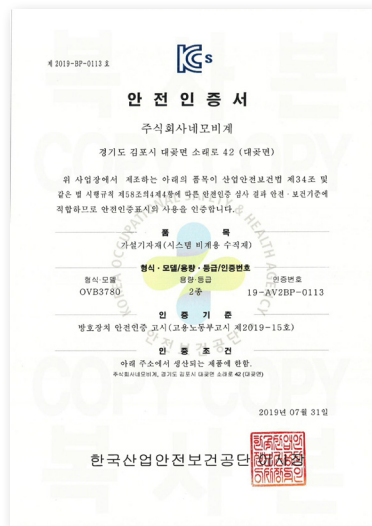

IOT SENSOR R&D DATA

- Building the technological foundation for the fifth industrial revolution
Safety smart policy
- In case of danger, real-time monitoring and alarms via sensors

Mandatory use of smart safety equipment using advanced technologies like IoT

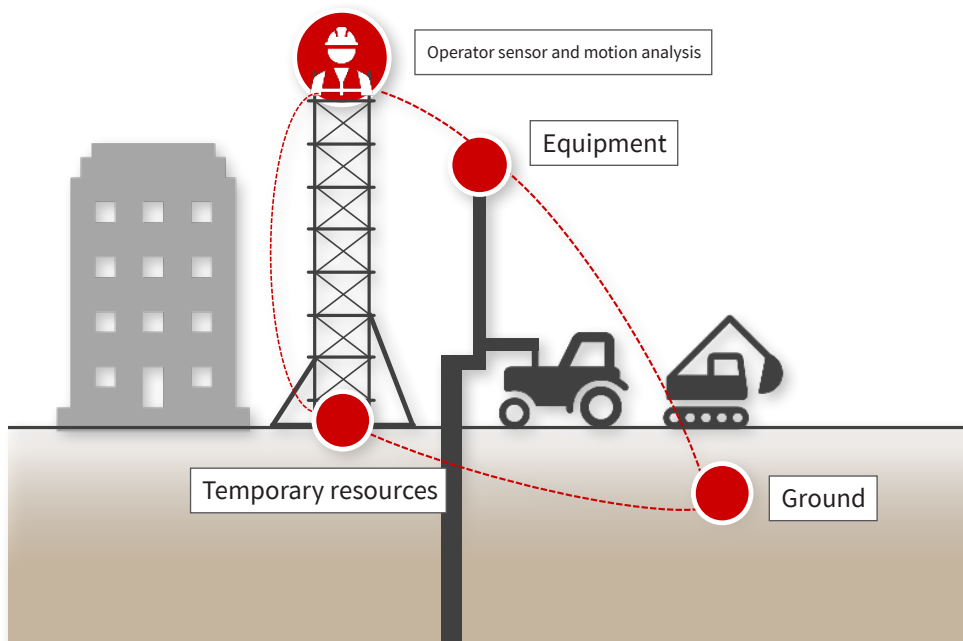

By a mobile phone,
if an appropriate
value is exceeded,
an alarm

Computer-linked
Safety Systems
Operation and Data
Management

Monitor structural deformation and abnormal conditions of scaffold systems

- Load monitoring system
- Displacement monitoring system
- Worker monitoring system
- IR Camera

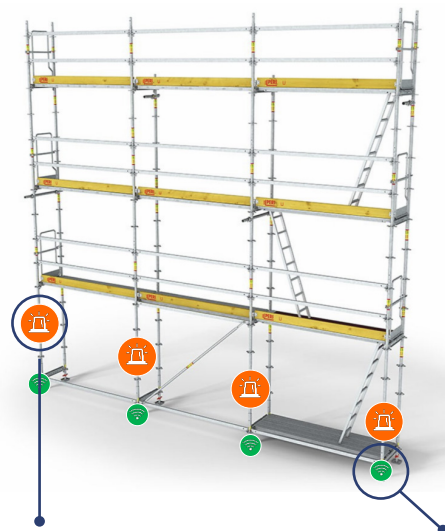

Sensor

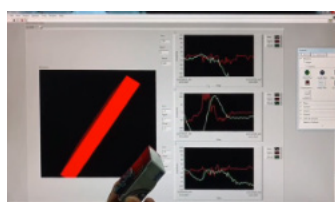

GPS • Wi-Fi
Transmitting, reception



Partners **ROTAL**
ROTAL
FA Total Solution™



NEO SCAFFOLDING

Neo scaffold Co.,Ltd

📍 **Office** GimpoangangLuxNine, 132, Gimpohangang 9-ro, 75beon-gil, Gimpo-si, Gyeonggi-do, Korea

📍 **Factory** 27-21, Dulleom-gil, Yangsan-si, Gyeongsangnam-do, Korea

T + 82 31-985-9140 / **F** +82 31-985-9147 (General Management Team)

T + 82 31-985-9141 / **F** +82 31-985-9149 (Design Team)

E neoscaf@gmail.com

📺 **YouTube** 'Neo scaffold Co.,Ltd'

www.neoscaffolding.com